

Bampton PumpTrack



Executive summary

In the last few years, there has been a huge rise in mountain biking, bike riding and skating. We feel there are inadequate facilities in our area for this growing passion. With the unfortunate increase of vandalism within the village it's become more obvious that there isn't enough facilities within the village for this age group. With some resorting to anti social behaviour to entertain themselves. This suggests there is not enough being done to address this and a Pump Track could well be the answer!

Pump Tracks are playgrounds and training facilities for anyone with wheels, including cyclists, skateboarders, roller blades, wheelchair users or scooter riders of all skill levels. Professionally designed and built, these asphalt tracks are hotspots for all kinds of riders who seek a fun and action-filled sports experience.

The Pump Track team namely – Adam Pagett and his team have been in discussions with Bampton Town Council to establish an ideal location for the pump track. This document reflects the conversations and the information required for submission and detailed discussion, prior to public consultation.

What are we trying to do?

Our intention is to create a community project to help deliver a truly outstanding facility in the Village of Bampton. Working with leading track designers engaging with the community to finance, design and build a track to cater for all ages and ability levels.

Why are we doing this?

Riders enjoy practicing the basic skills of carrying momentum, improving balance and building speed by using their arms and legs to 'pump' their bike/board/scooter around the track. As riders improve their skills, the tracks are designed to provide the option for more challenges with increased skill, without needing to change the construction. We believe this offers many positive benefits for the community, including:

- Help reduce the building of potentially dangerous and environmentally disruptive tracks and supporting the local wildlife trusts and authorities
- Reducing the risks on trails to local walkers, ramblers and horse riders with a dedicated local cycle track.
- Creating a safer and more controlled environment.
- Promoting physical health and mental wellbeing.
- Catering to all ages, building confidence and developing skills.
- Designed to make it accessible for wheelchair users.
- Minimal maintenance once built.
- Increase footfall to our local businesses.
- Support from professional track builders and pro riders.
- Volunteered help by local children gives them pride and motivation to help maintain the track and surrounding area.

It gives amazing and exciting opportunities for those with disabilities to feel comfortable in a controlled and friendly environment.

This initiative could have positive impacts on non-cyclists, walkers and horse riders in helping to reduce the potential for interaction within the local woodlands.

What are the concerns?

We are in discussion with the community to look at some very valid concerns and try hard to ensure we can adjust our model to work as effectively as possible. We base our findings below on research and experience from industry professionals and the highly experienced track design team.

Environmental - this is so important to understand the effect on the local environment. During the process we would undertake an arboreal report to identify the recommended root protection areas, assessment of impact and ensure there are no TPOs (tree preservation orders). Only once this is done would we move to the design phase. Under the track we would ensure there is adequate mesh to protect the roots as well and ensure the track has longevity. Where there are no trees, we would ensure to minimise any wildlife/fauna damage and work towards replacing and relocating.

Noise - the asphalt track is not a noisy substrate and from the above teams experience the tracks are generally quiet with the rubber tyres of smooth surface quieter than concrete or rough soil surface. There will always be noise of people enjoying themselves and laughing - that is unavoidable with an outdoor play area.

Parking - As this is a pump track, most people will come by bike. We need to ensure there is emergency access and also parking for disability vehicles to enable access for everyone. The proposed site is adjacent to the school carpark as such any impact by visiting traffic should be minimal.

Anti-social Behaviour and Mess - we live in a world where this unfortunately is common. Getting all the community, including school children and youths engaged right from the beginning, it is found they gain an element of responsibility and with that respect for the space. We would encourage people of all ages to come to the track building days to give them ownership and have fun with other residents. Many tracks around the UK run clean up days and appoint youth ambassadors at schools and youth clubs to help reinforce the Pump Track is theirs and it is important to keep it clean and respect the environment and the community surrounding the track.

The demographic is different to a skate park - it is somewhat broader with a wider age range of people using it. It is more inclusive than a skate park as little ones can start with a low skill level, (compared to a skate park which needs an element of understanding before they go there, slightly older and they tend to be unsupervised). A pump track will have a much larger age range of visitors, due to there being younger visitors and as such there is an element of passive supervision by parents and adults, which generally improves the behaviour of the older children/teenagers. As a parent, we realise that teenagers will always find somewhere to hang out, surely it is more reassuring that they have a better, safer place to go?

Locations Considered

We have looked at multiple sites in the Bampton area but The old quarry bowl in the Millennium Green stands out to us as the site with most potential and the least impact.

We have taken measurements of the area and have worked our initial concept to take in the surrounding landscape and be as sympathetic to its surroundings as possible. The Blue Square in the image Below shows the proposed location next to the school.



There has previously been locally built bike jumps in the quarry bowl constructed out of materials that have been previously left behind by various projects over the years. As a natural bowl with a flat bottom area it lends its self naturally to the installation of a PumpTrack.

The PumpTrack can be incorporated into the existing site with a little adjustment and extension. To make this suitable for all levels we would incorporate wider, flatter areas within the track, which can be used by wheelchair users and buggy pushers. We would also incorporate straights which can be used as either a multitude of bumps or consolidated jumps for the more experienced riders.

In its current state the Old Quarry bowl provides no real benefits or uses to the local community, the recent tree works has left the location looking neglected and un kept, this PumpTrack project would give the location a new lease of life and give it a bespoke purpose.

What could it look like?

Below are a selection of images of different tracks which Forte Trailscapes and Dutch Architects have designed. If we were able to get space approved we would work closely with the community and would engage with the track builders and design a track fit for everyone one. The proposed plan isn't just for a PumpTrack but also includes other facilities aimed at the "teen" age group like a climbing stumps and social areas and spectator seating. Through the Public tender phase we will welcome in additional ideas around this area.

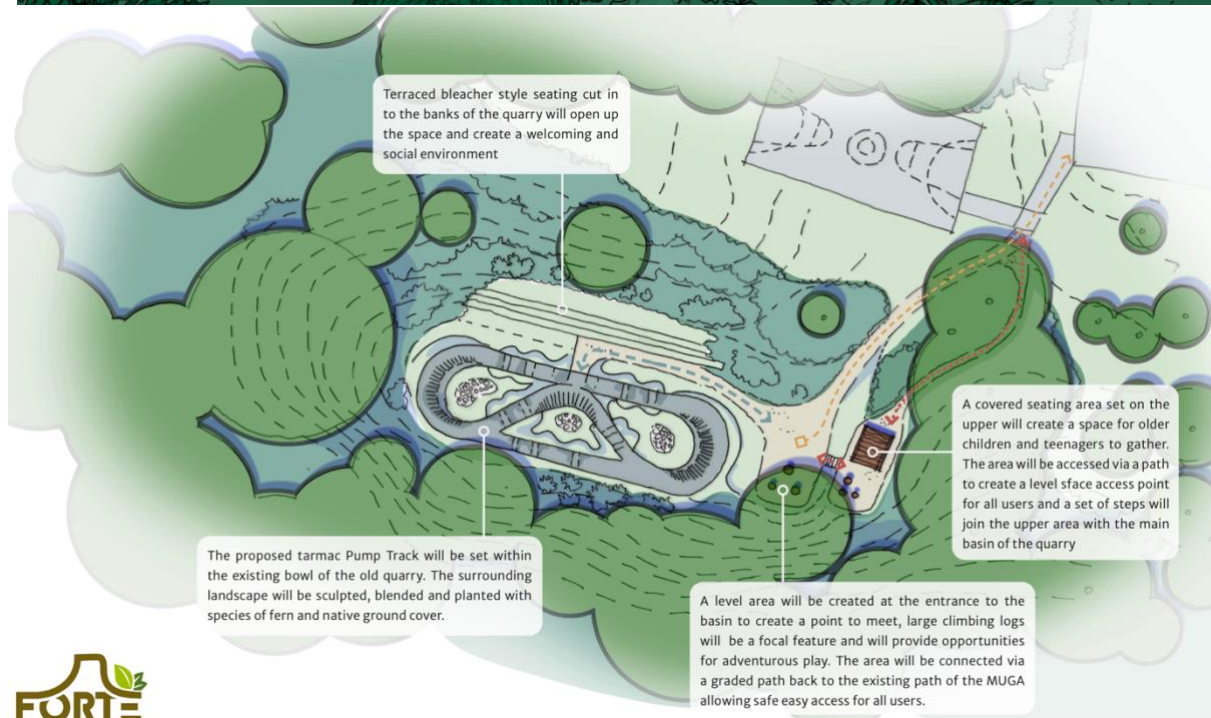
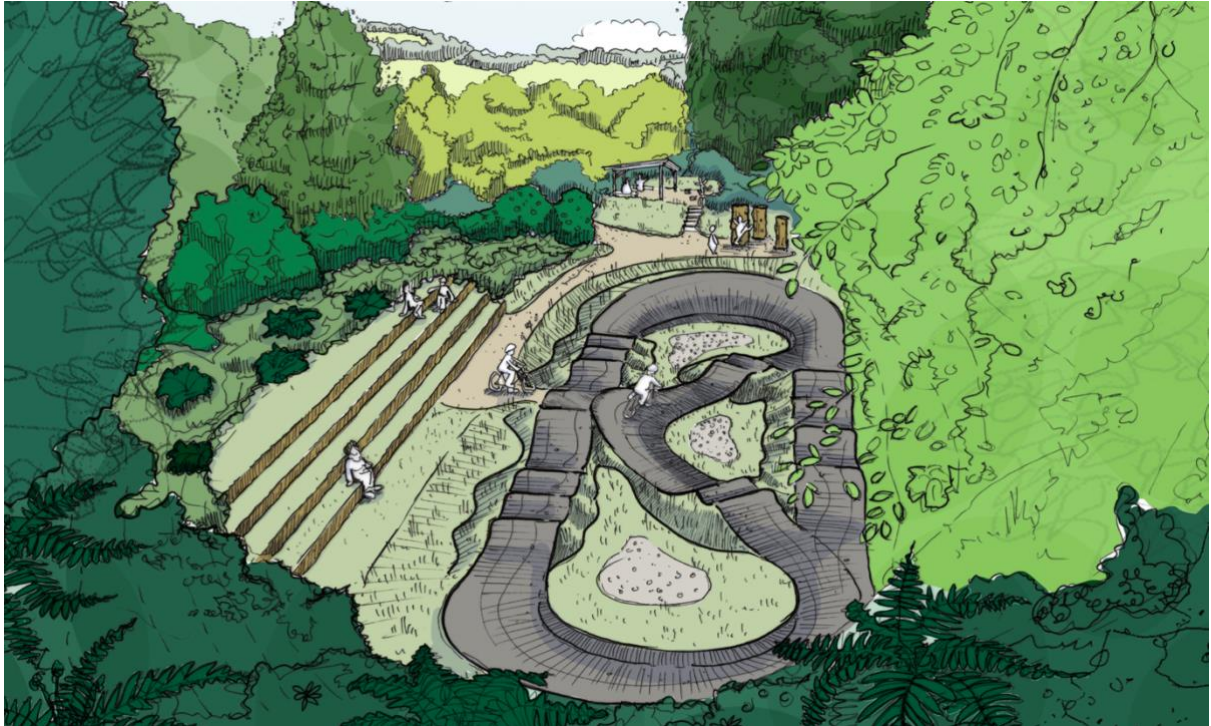



[Financial Costs and Plan](#)

After our initial meeting with the track builders, until we proceed with an accurate scaled drawing and survey, they were only able to provide a budgetary estimate between £40,000 and £50,000. Now with the support of the council using Section 105 funds we can commission an architect to survey the site and provide us with detailed plans for planning permission and tendering out the construction.

The Next Phase will be a Public consultation gauging the local interest in the project and formalise the councils approval.

[What Now](#)

We are now entering the Public Consultation Phase of the project with a view to gather enough evidence that the community has a desire for this project to go ahead on Council Land so that Bampton Council can make an educated and informed discussion on the project.

We would love to hear from you regards this project and the wider teen facilities that are been proposed. We have used a google Questionnaire form and this can be found by pointing your smartphone camera at the code below.



[In Summary](#)

We have the passion to provide many generations with an exciting and well maintained facility and have demonstrated how beneficial this track would be to the local community for years to come.

We look forward to any questions, thoughts, and suggestions you may have. Please feel free to email me at adampagett@hotmail.com

We look forward to hearing from you.

Adam Pagett and the team

